



by Weyerhaeuser

2x6 TIMBERSTRAND® LSL OR
EQUIVALENT BLOCK WITH GRAIN
ORIENTED VERTICALLY AND A
MINIMUM $\frac{1}{4}$ " GAP BETWEEN BLOCK
AND FLANGE.

SIDE VIEW

TWO VERTICAL ROWS OF THREE
10d (3") COMMON NAILS,
CLINCHED. (6 NAILS TOTAL)

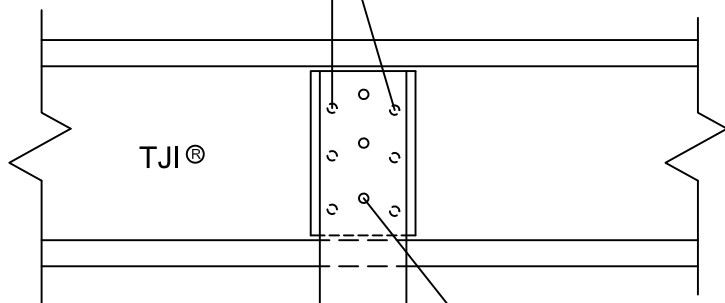

MAX. 250lbs

**THIS CONNECTION YIELDS
A MAXIMUM OF 250lbs OF
DOWNWARD FORCE.
CLOSEST SPACING, 30"
FROM NEAREST SIMILAR
ATTACHMENT.**

JOIST MUST BE DESIGNED
WITH THE ADDITIONAL
POINT LOAD(S) APPLIED.

ATTACH A 2x4x_ TIMBERSTRAND®
LSL OR EQUIVALENT TO THE BLOCK
WITH THREE (3) 10d COMMON NAILS.

NOTE: ROWS NEED TO BE $\frac{3}{4}$ "
APART, SPACING WITHIN ROW IS 2".

NOTE:

**FOR ALL 9 $\frac{1}{2}$ " DEEP JOISTS, ATTACH BLOCK TO
WEB OF JOIST WITH (4) 10d NAILS. CONNECT THE
2x4 SOFFIT ATTACHMENT TO THE BLOCK WITH (2)
10d NAIL.**

**MAXIMUM VERTICAL LOAD FOR ALL 9 $\frac{1}{2}$ " DEEP
JOISTS IS 200 lbs.**

SECTION VIEW

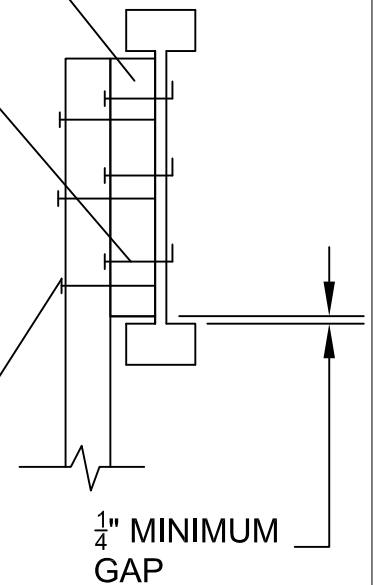

HANGING SOFFIT MATERIAL FROM TJI® JOISTS

PRODUCT APPLICATION

ASSURANCE

DO IT RIGHT
FIRST !!

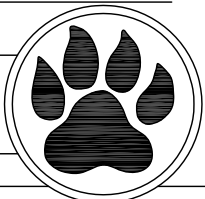

WESTERN DIVISION

PHONE: 888-iLEVEL8

FAX: 253-925-2896

WestTechTeam@weyerhaeuser.com