



TRUS JOIST® 1½" TIMBERSTRAND® LSL RIM BOARD

For Residential Framing Applications

- More Cost-Effective Solution Than 1¾" Rim Board
- Results in Fewer Shiners
- Meets Code Requirements
- Increases Framing Productivity
- Offers Wide Nailing Surface
- Limited Product Warranty



#R03-05 TECHNICAL BRIEF

Specify 1½" TimberStrand® LSL instead of 1¾" and still get the strength you need.

Over the years, your choices for rim board have grown from 1¼" to 1¾". But 1½" TimberStrand® LSL rim board offers the best of both worlds. It delivers the right degree of strength, and its wider nailing surface adds confidence to your installation.

Rim Board Installation

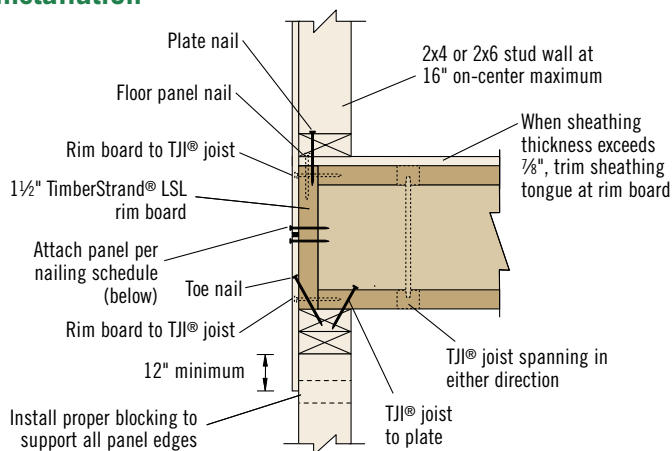
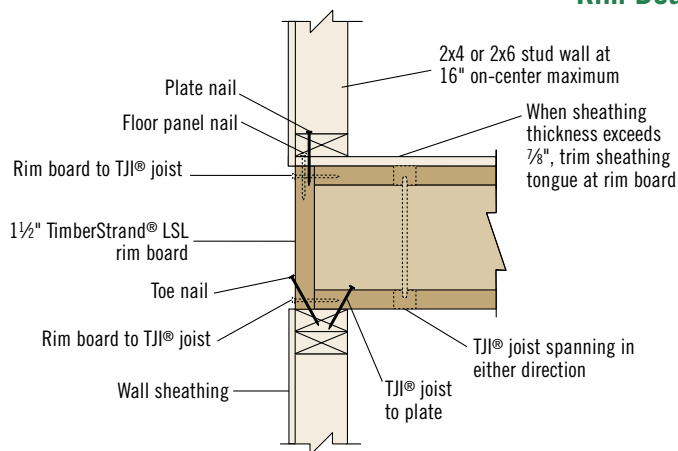

A3.2 **A3.3** See the *iLevel Rim Board Specifier's Guide (Reorder #TJ-8000)* for more detail options

A3.4

Specifications		Rim Board Installation Detail		
		A3.2 ⁽¹⁾⁽²⁾	A3.3 ⁽¹⁾	A3.4 ⁽¹⁾
Rim Board Thickness		1½"	1½"	1½"
Plate Nail—16d (0.135" x 3½") box		12" o.c.	8" o.c.	12" o.c.
Floor Panel Nail—8d (0.131" x 2½") common		6" o.c.	6" o.c.	6" o.c.
Rim board to TJI® joist—10d (0.128" x 3") box		One into each flange		
Toe Nail—10d (0.128" x 3") box		6" o.c.	4" o.c.	6" o.c.
TJI® joist to plate—8d (0.113" x 2½") box		Two nails, one at an angle into flange each side of web at least 1½" from end		
Sill Plate Anchor Bolt		½" dia. at 6' o.c. ⁽³⁾	⅝" dia. at 6' o.c. ⁽⁴⁾	⅝" dia. at 4' o.c.
Wall Framing	Exterior Face	Sheathing	7/16" structural 1 sheathing ⁽⁵⁾	3/8" structural 1 sheathing in all areas ⁽⁶⁾
		Boundary Nailing	8d common at 6" o.c.	8d common at 4" o.c.
		Intermediate Nailing	8d common at 12" o.c.	8d common at 12" o.c.
		Max. Window Opening Height	5'-4" ⁽⁷⁾	5'-4" ⁽⁷⁾
		% of Wall with Full Height Sheathing	70%	70%
	Interior Face	Sheathing	Per Code	½" gypsum
Boundary Nailing	Per Code	5d cooler at 7" o.c.	5d cooler at 7" o.c.	
Intermediate Nailing	Per Code	5d cooler at 10" o.c.	5d cooler at 10" o.c.	
Hold-Downs	90 mph Wind Zone	none		
	120 mph Wind Zone	16" o.c. within 6' of corners ⁽⁸⁾	16" o.c. within 4' of corners ⁽⁸⁾	none

- (1) All sheathing shall be properly blocked and nailed.
- (2) Verify the lateral capacity of the wall. Not all types of code-allowed wall construction provide the same lateral resistance. Check with your local building official or design professional.
- (3) For 120 mph wind speed, place bolts at 3'-6" on-center.
- (4) For 120 mph wind speed, place bolts at 4' on-center.
- (5) Detail A3.3 shall be a segmented wall, location of full-height structural sheathing per code.
- (6) Sheathing shall be continuous over all plate-to-plate and plate-to-rim board interfaces and may butt together at mid-depth of rim board as shown in A3.4. At foundation, fasten the bottom edge of the sheathing to the sill plate.
- (7) In addition, one 6'-8" standard door opening is allowed.
- (8) If required, hold-downs shall be Simpson Strong-Tie™ CS20 (or equivalent) straps attached with four 8d common nails at each end. As an alternative to hold-down straps, wall sheathing may be attached as shown in A3.4. See footnote 6.

Allowable Design Stresses (100% Load Duration)

Modulus of elasticity	E =	1.3 x 10 ⁶ psi
Shear modulus of elasticity	G =	81,250 psi
Flexural stress	F _b =	1,700 psi ⁽¹⁾
Compression perpendicular to grain	F _{c⊥} =	680 psi ⁽²⁾
Compression parallel to grain	F _c =	1,400 psi
Horizontal shear parallel to grain	F _v =	400 psi
Vertical load capacity	=	4,250 plf ⁽³⁾

(1) For 12" depth. For others depths, multiply by $[\frac{12}{d}]^{0.092}$

(2) F_{c⊥} shall not be increased for duration of load.

(3) 4,140 plf for depths greater than 16".

TimberStrand® LSL rim board is intended for dry-use applications

Code Evaluation: See ICC ES ESR-1387

Call your iLevel representative today to order the 1½" TimberStrand® LSL Rim Board. 1.888.453.8358

March 2007
Reorder R03-05

This document supersedes all previous versions. If this is more than one year old, contact your dealer or iLevel rep.
TR

▲Weyerhaeuser, TimberStrand®, and Trus Joist® are registered trademarks and iLevel™ is a trademark of Weyerhaeuser. © 2007 Weyerhaeuser Company. All rights reserved. Printed in the USA.